

WEST ELEVATION

1/4" = 1'-0"

EXTERIOR BRACED WALL NOTE:  
Continuous exterior sheathing minimum 7/16"  
APA Rated Panel with 8d nails @ 6" o.c. edge  
nailing and 12" o.c. field nailing.

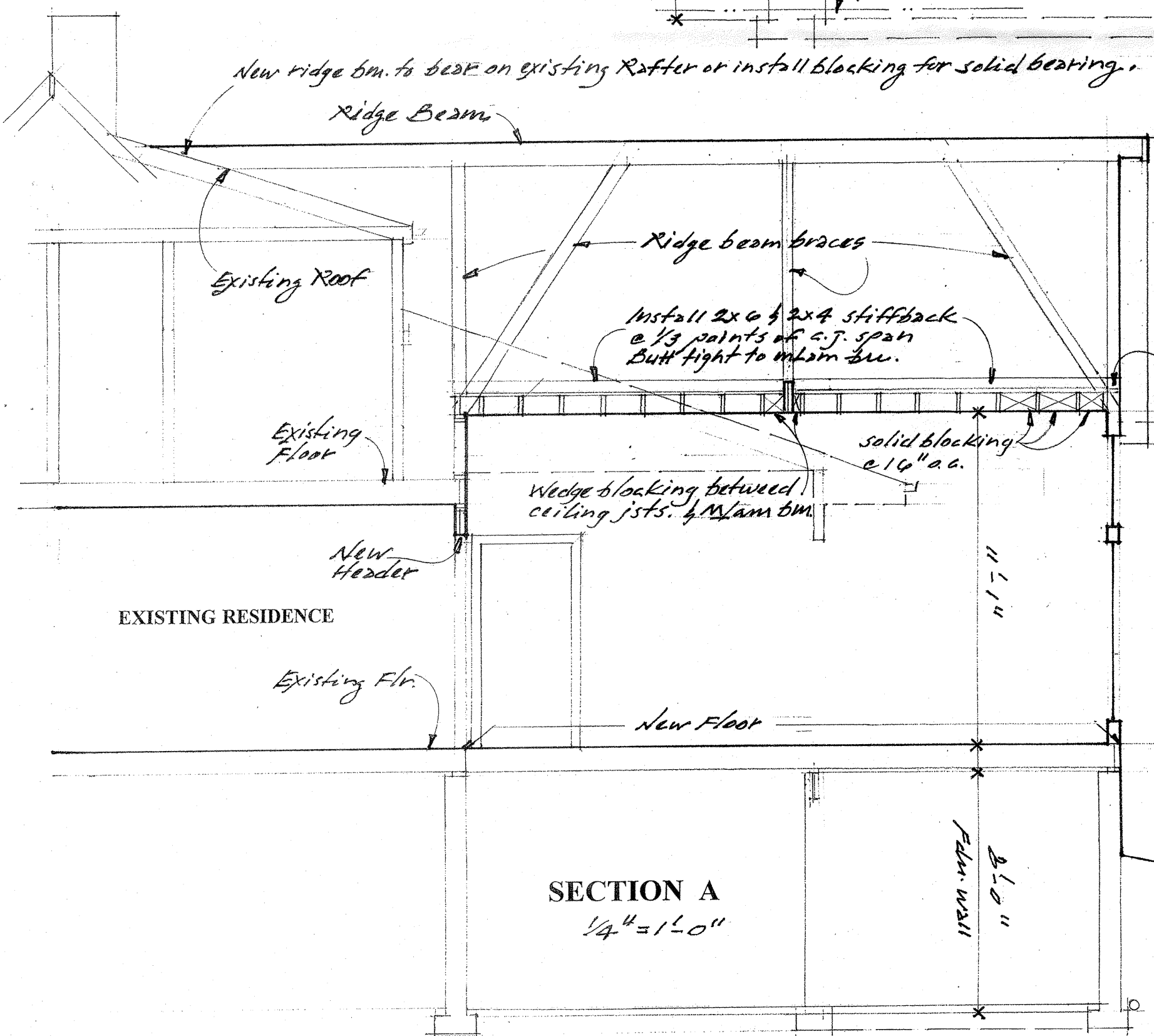

SECTION A

1/4" = 1'-0"

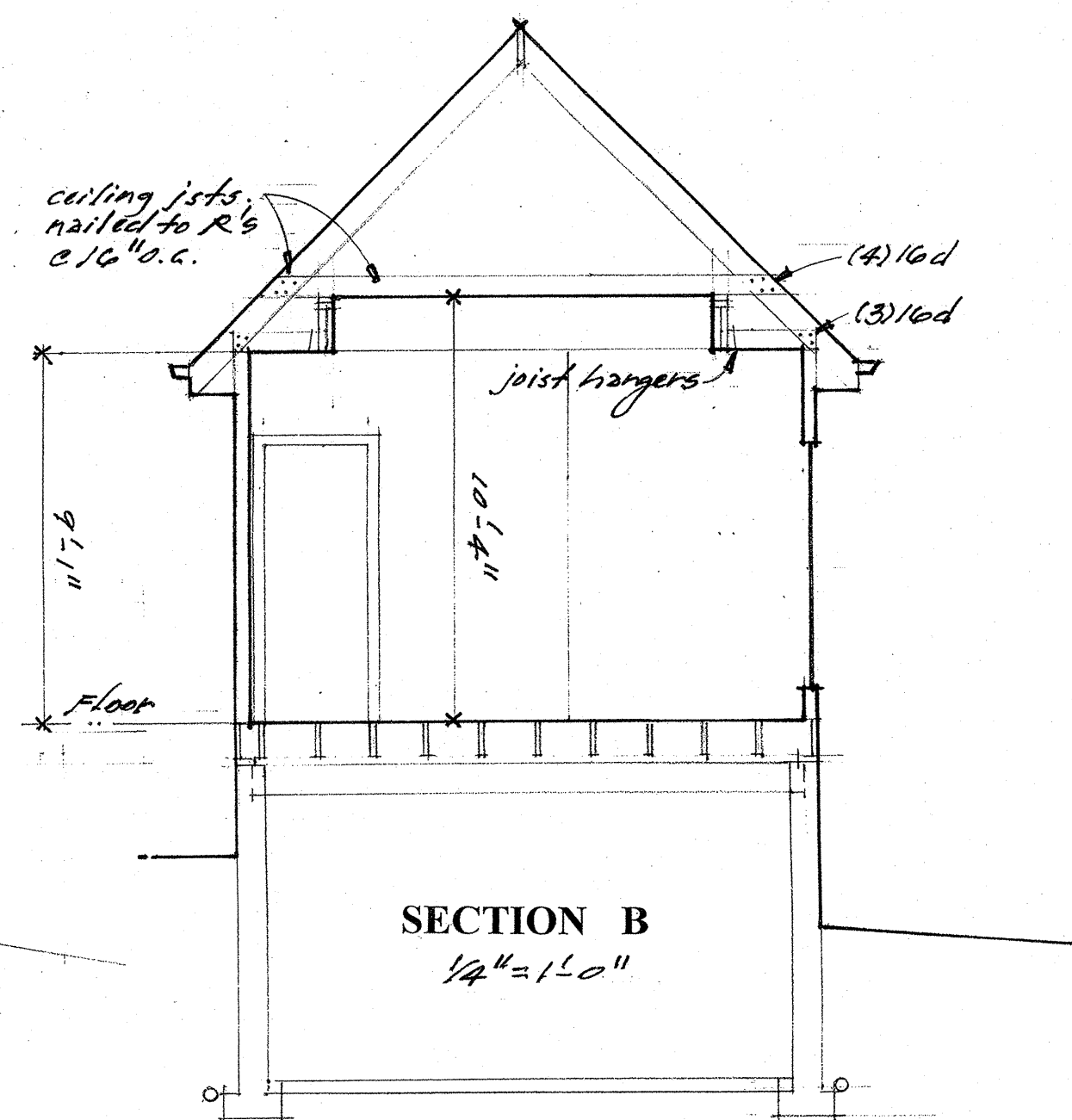

SECTION B

1/4" = 1'-0"

SELF RESIDENCE